

SSB 32

Safety Swivel Break DN 32

Reusable Safety Break corresponding to EN 13617 -2

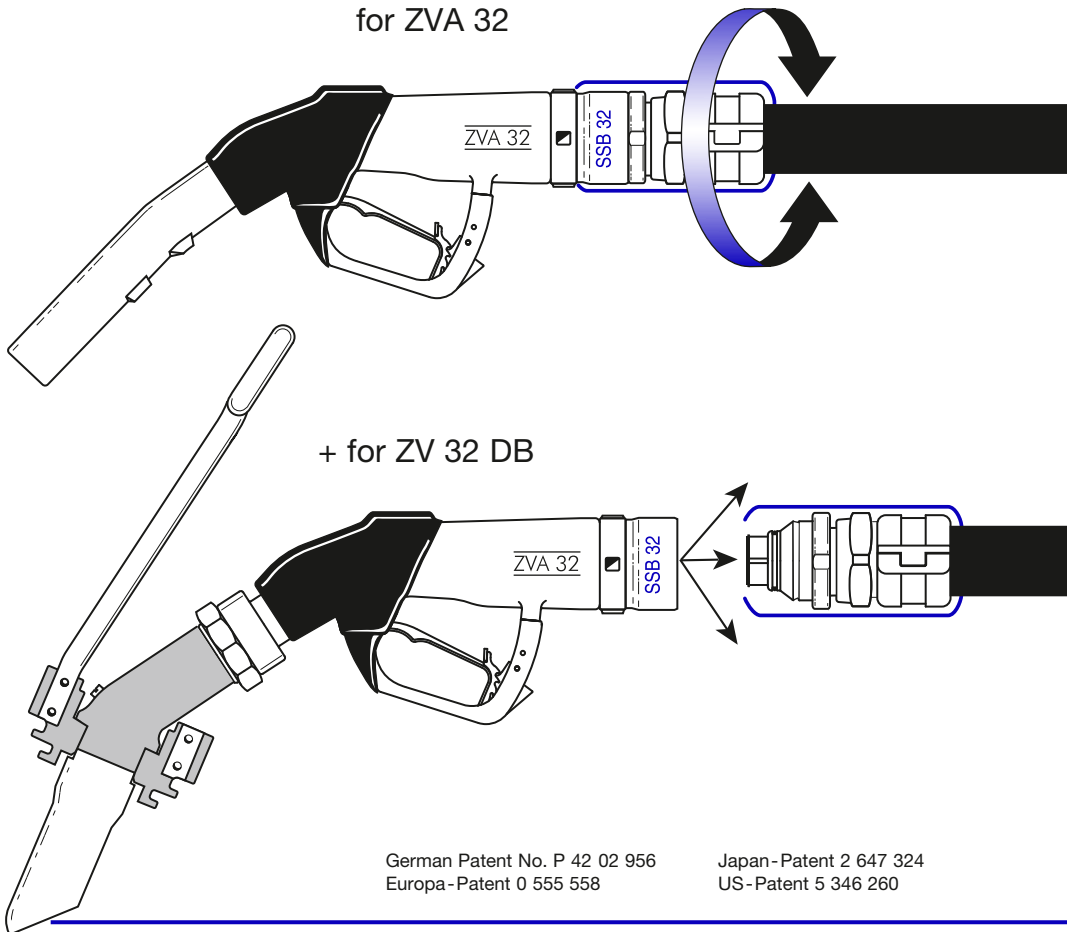

German Patent No. P 42 02 956
Europa-Patent 0 555 558

Japan-Patent 2 647 324
US-Patent 5 346 260

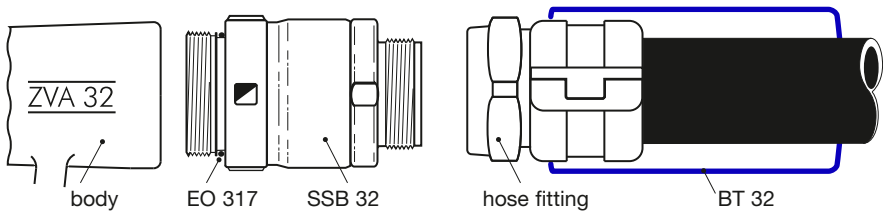

The SAFETY SWIVEL BREAK **SSB 32** is a self-sealing reusable break-away coupling designed to protect the pump against damage which can occur drive-off accidents. As a nozzle break it is fitted between the ZVA 32 (or non-automatic ZV 32 DB with „Renk“ coupling for diesel locomotive refuelling) and the hose assembly. Before delivery each **SSB 32** is tested regarding the break-off and tightness under pressure to standard EN 13617-2. This is documented by the embossed factory date code, e.g. ,1059' for 1 = Monday; 05 = calendar week; 9 = year 2019. According to EN 13617-2 the coupling separates at a pull force between 80 kg (800 N) and 150 kg (1500 N) in an axial and angular direction.

NOTE : Ensure that the dispenser allows the maximum pull force in all approach directions without damage.

An integral valve at the break-away part stops the flow of fuel at the hose end. After separation the **SSB 32** must be reassembled by an authorized service engineer according to the instructions opposite page and may then be used again after leakage test.

INSTALLATION INSTRUCTIONS

- Switch off pump. Release pressure in hose.
- Remove nozzle from hose assembly with the hook spanner EW - H 68/75 or EW - GH 60/90 and drain hose.
- Remove existing swivel (EA 318/318.4) from nozzle.
- Slightly lubricate thread; screw **SSB 32** into the nozzle.
- Pull the cover **BT 32** back over the hose (see picture 1).
- Lubricate thread and screw **SSB 32** onto the hose assembly.
- Push cover **BT 32** on **SSB 32** (see picture 2).
- Prime pump and check carefully to ensure connections are tight.

The drawing below shows the assembled system.

The break cover **BT** helps protect the break-away part against external damage in the event of a drive-off.

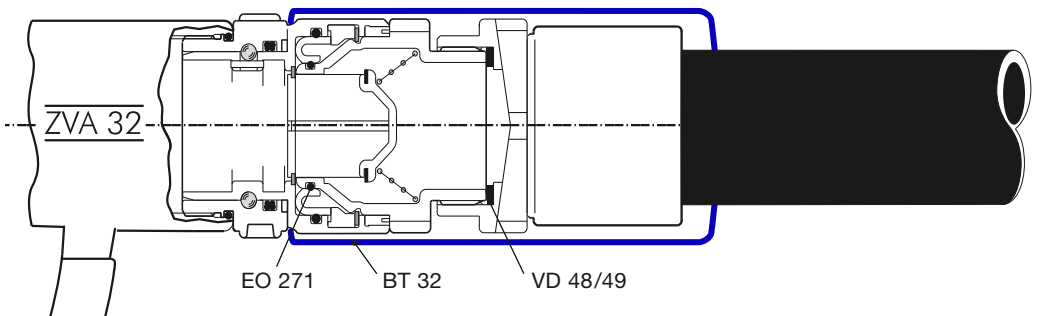

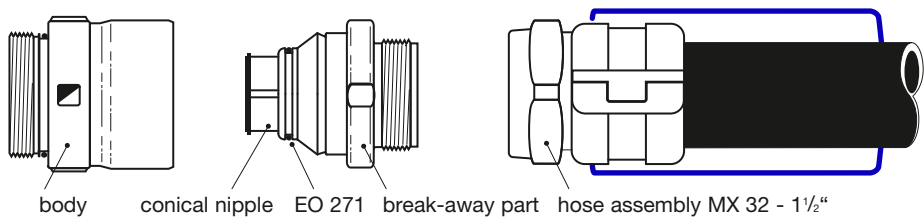

REASSEMBLY AFTER SEPARATION

NOTE: This work must only be done by an authorised service engineer who is trained to ensure compliance with all relevant national regulatory conditions. He should also test and check the dispenser, nozzle and hose connections for possible damage. The whole system is then subjected to a pressure test before putting back into service.

WARNING : This leaflet contains important information which must be read prior to assembly equipment. The responsible person must observe their company's procedures and safety regulations taken into account. Fuelling equipment should regularly be visually inspected on site to ensure it is undamaged.

Following instructions have to be observed for re-assembly:

- a) Switch off pump. Release pressure in hose.
- b) Push break cover **BT 32** back over the hose assembly.
- c) Thereafter unscrew SSB body from nozzle. Unscrew break-away part from hose. Drain hose.
- d) Clean all parts and check them for damages caused by the accident like ovalness other deformations or broken plastic parts. With such damage, the safety break coupling may not be reused. The visible O-rings EO 271 are available as spare parts. The body and break-away part shall not be separately replaced or substituted.
- e) Slightly lubricate all metallic sliding surfaces of the body and the break-away part and the groove for the circlip as well as the O-ring.
- f) Hold body in vertical position and center the circlip inside by hand. Test if the conical nipple can be moved freely. Fit the break-away part carefully into the body. Both have to be in straight line.
- g) Hold parts centric and press them together with the flat clamping surfaces a vice. Make sure that both parts remain aligned axially until they snap together visibly and audibly.

Thereafter reconnect **SSB 32** with **BT 32** again between nozzle and hose assembly as described opposite and test for tightness.

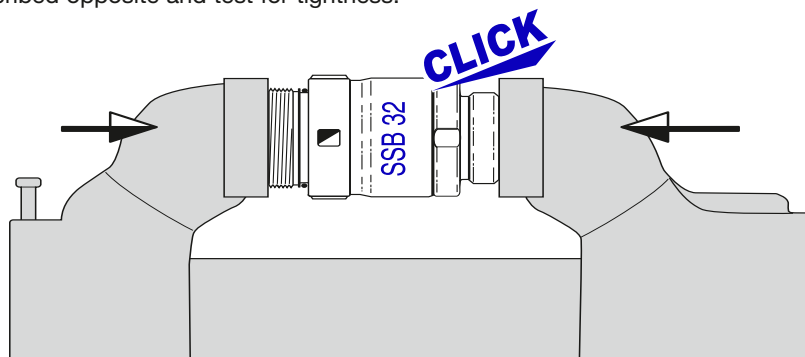

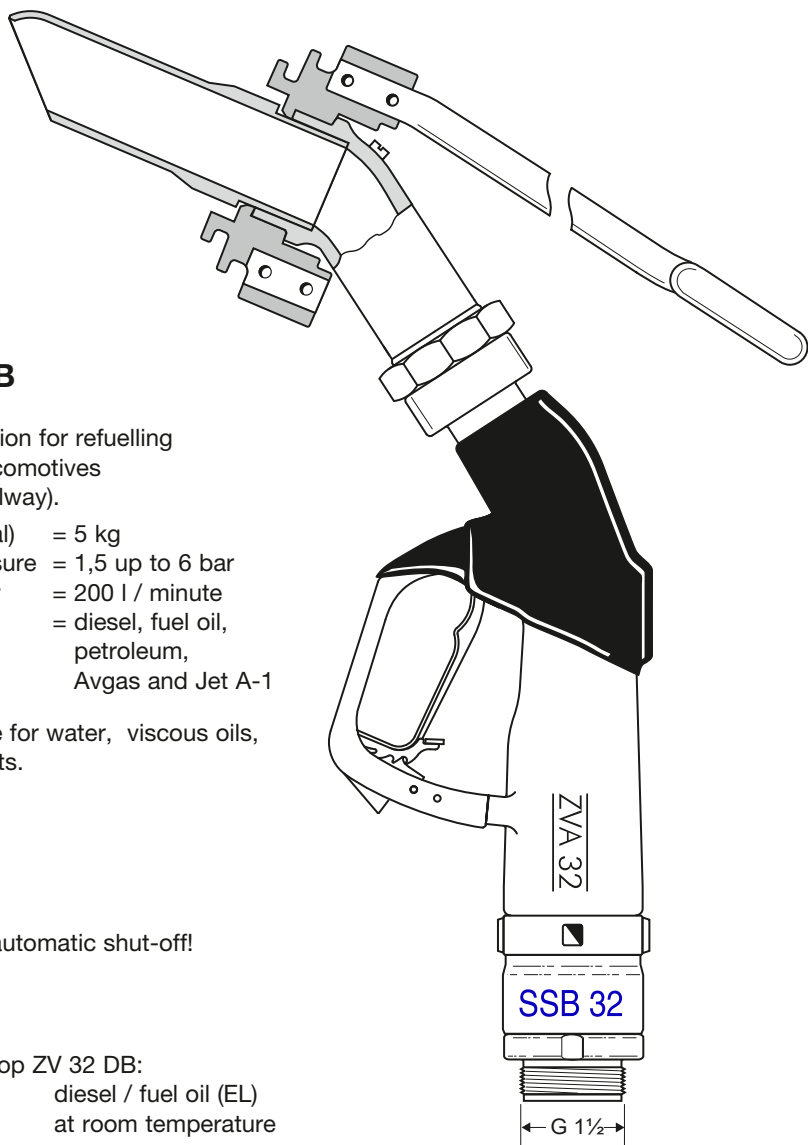

ZV 32 DB

Special edition for refuelling
of diesel locomotives
(German railway).

Weight (total) = 5 kg
 Work. pressure = 1,5 up to 6 bar
 Max. power = 200 l / minute
 Media = diesel, fuel oil,
 petroleum,
 Avgas and Jet A-1

Not suitable for water, viscous oils,
and solvents.

NOTE: No automatic shut-off!

Pressure drop ZV 32 DB:
diesel / fuel oil (EL)
at room temperature

